

### GPS DRONE

GPS enabled flight is intended for **outdoor use only**. Attempting to fly indoors may result in erratic behavior.

#### POWERING UP AND PAIRING REMOTE

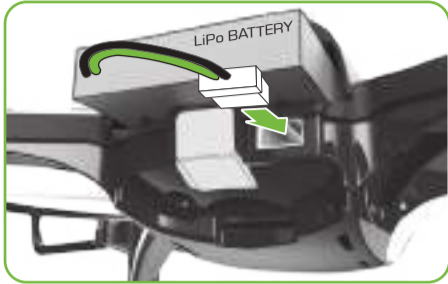

Insert fully charged LiPo battery.



Place the drone on level surface with a clear view of the sky.



Turn on controller. Once paired with the drone, **RED SEARCH LED** will blink while acquiring GPS signal.



Once **GREEN LOCK LED** turns on solid, the drone is ready to fly.

#### FLIGHT CONTROLS

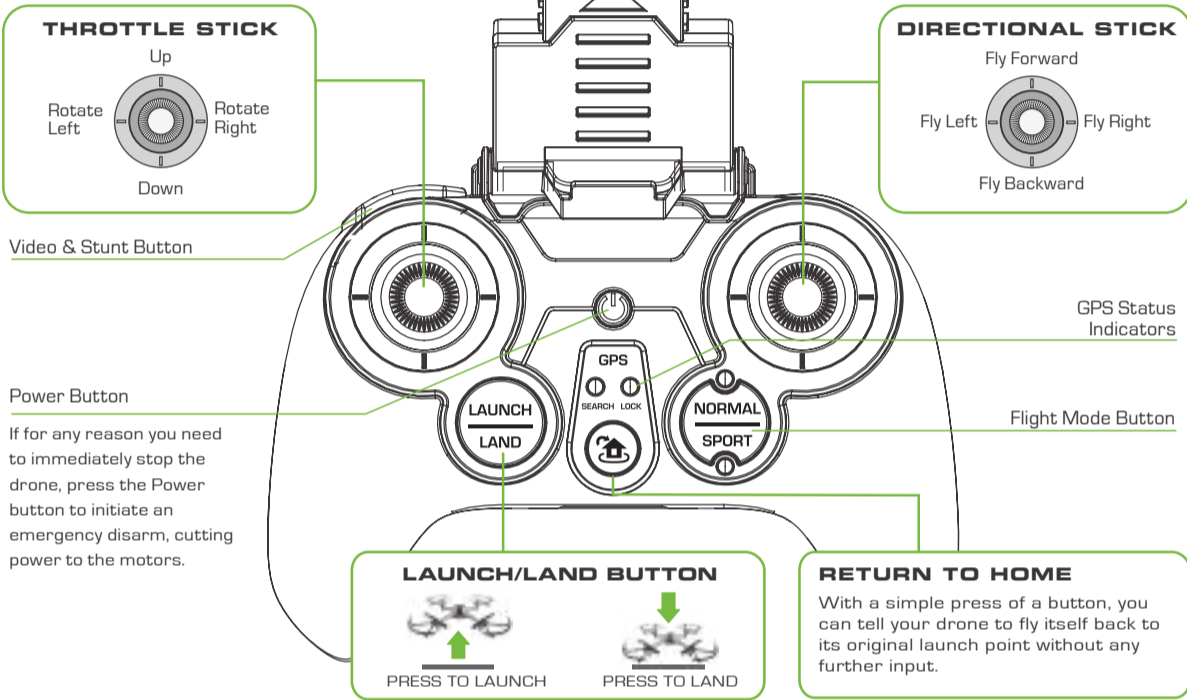

#### FLIGHT BASICS

To make flying easier, place the drone on the ground in front of you with the drone facing away from you (green blades forward). You should be facing the same way the drone is facing.

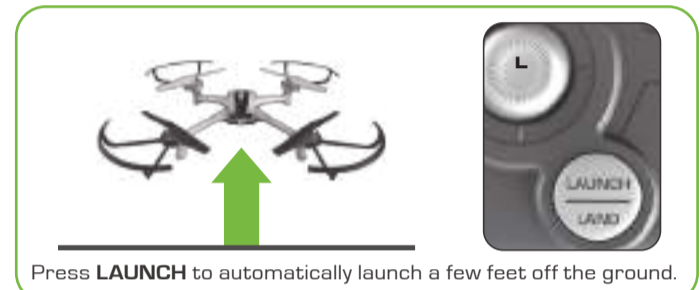

Press **LAUNCH** to automatically launch a few feet off the ground.



Move **Throttle** thumbstick up or down to make drone fly higher or lower and left or right to rotate.



Use **Directional** thumbstick to fly forward, backward, left or right.

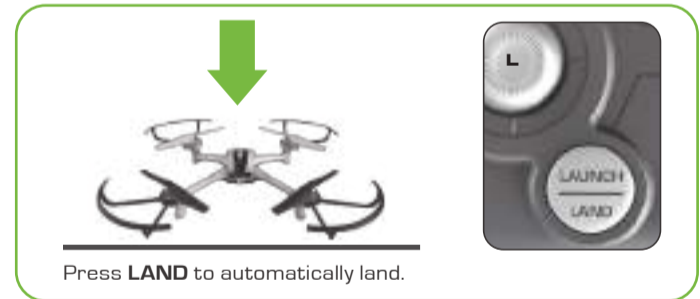

Press **LAND** to automatically land.

You can also manually land the drone by holding throttle in the down position to descend. Continue holding down once the drone reaches the ground. When the drone recognizes it has landed, the controller will play two beeps and the propellers will stop spinning.

#### FLIGHT MODES

**NORMAL** mode is best for new pilots or those who want a casual flying experience. In **NORMAL** mode, the drone reacts smoothly to the pilot's input for easy control.



**SPORT** mode allows for experienced pilots to perform more aggressive maneuvers. The drone's response rate to pilot input is much higher for sharper turns and more speed.



- **MODES** can be customized in the **SKY VIPER VIDEO VIEWER 2.0** app

#### POSITION HOLD

Position Hold uses GPS to maintain a perfect hover. It also prevents drifting when you have no hands on the controller. Position Hold is active in both **NORMAL** and **SPORT** modes.

#### HIGH PERFORMANCE FLIGHT MODES (for experienced pilots)

For experienced pilots who prefer full manual control, Position Hold can be deactivated. With the drone powered ON but not flying, hold the Flight Mode button and push the throttle stick to the right. The remote will beep and Flight Mode LEDs will flash to confirm deactivation. To re-activate, repeat this step and push the throttle stick to the left instead of right—You may also turn the drone off then on again to reset.

#### RETURN TO HOME

- Once the drone has **GPS LOCK**, its **HOME** is set to its current location when you launch.
- With a simple press of a button, you can tell your drone to fly itself back to its original launch point without any further input.
- During this return flight, you will still have altitude and direction control to avoid obstacles.
- The return flight can be canceled by pressing the Flight Mode or Land buttons.
- When using the **Sky Viper Video Viewer 2.0** app, you can return to your device's GPS location instead.

#### FOLLOW ME MODE

With **Sky Viper Video Viewer 2.0** app, you can enable Follow Me mode, in which the drone will maintain a set distance from your device's GPS location. See app for more details and safety precautions.

#### CAUTION:

**Return to Home** and **Follow Me** modes do not have object avoidance detection. Use safety precautions when flying near trees, buildings, people or animals. Do not use while in a vehicle, on a skateboard/scooter/hoverboard or riding a bicycle. Read all enclosed information before operating.

#### STREAMING AND RECORDING VIDEO

**DOWNLOAD THE SKY VIPER VIDEO VIEWER 2.0 APP FROM THE APP STORE OR GOOGLE PLAY.**



- Open your device's WiFi setting and select the network starting with **SKYVIPER\_**
- Default WiFi password : skyviper
- Open the SkyViper Video View 2.0 app.
- To reset drone WiFi password to the default, plug battery into drone and place upside-down on a flat surface, turn on controller and wait for them to pair, hold both video & stunt buttons for 5 seconds until you hear a beep from the controller and the drone's LEDs flash.

**RECORDING HIGHER QUALITY VIDEO TO MICRO SD CARD**

(MICRO SD CARD NOT INCLUDED)

Inserting a microSD card into the drone allows you to record and playback video at a much higher frame rate and viewing quality, also eliminating loss of video quality when flying at longer ranges. Supports microSD cards up to 32GB and recommend Class 6 or higher for best quality.



#### ONE TOUCH STUNTS

##### BARREL ROLL LEFT OR RIGHT

While flying forward (or reverse), tap the **STUNT** button.

##### FLIP IN 4 DIRECTIONS

While hovering, hold the **STUNT** button and tap the direction stick in the direction you want the drone to flip.

#### CAUTION!

The drone should be flying at least 10 feet in the air with a minimum clearance of 10 feet in all directions before attempting stunt functions.

#### ADJUSTABLE CAMERA ANGLE

The drone camera angle is adjustable to suit your preference. Point forward for recording flying action, straight down for aerial photos.



(Remove protective film from lens before use.)

### REPLACING DAMAGED BLADES

Use the included screwdriver to unscrew the propeller, then pull up on propeller to detach. Match A propellers to A legs and B propellers to B legs. Replace screws and tighten.

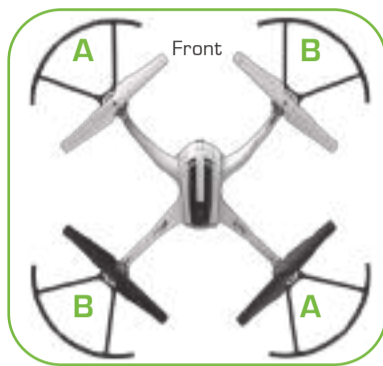
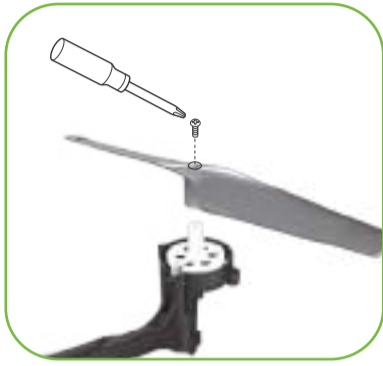

### CONTENTS

- GPS Drone
- USB Charging Cable
- Rechargeable 3.7V 1200 mAh LiPo Battery
- Controller
- Phone Mount
- 4 Replacement Blades
- 4 Blade Guards
- Screwdriver & Extra Screws

### REPLACEMENT BATTERY AVAILABLE

Increase your flying time with an additional battery!

Details of how to purchase additional or replacement battery packs available at [SKYVIPER.COM](http://SKYVIPER.COM)

#01846

### INSTALLING BATTERIES IN THE CONTROLLER

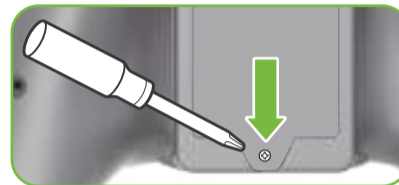

\*Batteries not included.

### CONNECTING BATTERY



Open the battery latch  
(Press back of latch and lift up)



Insert battery



Close the battery latch



Connect the battery

### CHARGING THE LiPo BATTERY

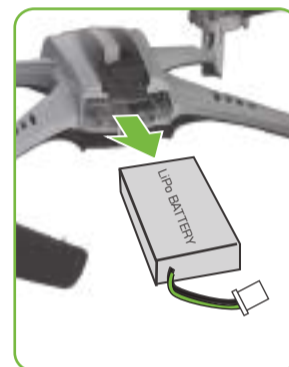

Remove LiPo battery from compartment and unplug cable

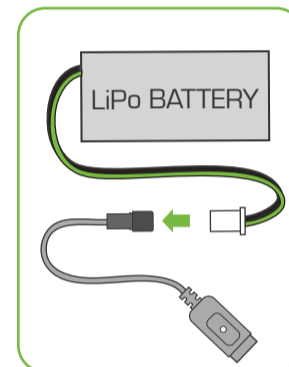

Plug battery into USB charging cable

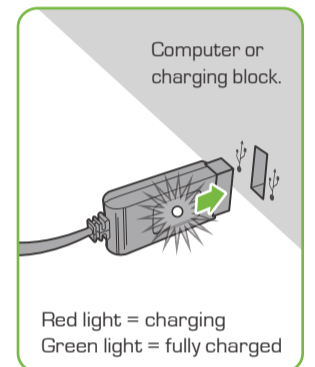

Insert charging cable into USB charging block or computer. Charge until light turns green then unplug.

#### CHARGING PRECAUTIONS:

- After use, allow battery to cool down to room temperature before charging again.
- Charge battery in an isolated area, away from excessive heat or moisture.
- If you suspect that the battery is damaged or swelling, discard the battery in accordance with your country's recycling laws.
- Do not modify, heat, or wet the battery in any way. Only recharge with provided charger.

### ADULT SUPERVISION REQUIRED

Before each use, an adult should check this product and the LiPo battery to ensure no damage or hazards exist. Drone has rotating blades that move at high speed, posing danger of damage and injury. Use of included blade guards strongly recommended. Pilots are responsible for any actions that result in damage or injury from the improper operation of drone. Adequate flying space is required. Avoid flying near interior fans and/or vents as they may make flying difficult to control. Keep a safe distance away from streets, public thoroughfares and power lines. Never attempt to retrieve drone from any location higher than your reach (such as rooftops or trees) or from any location that poses a safety hazard. Never fly drone at night. Keep drone in sight at all times during operation. Discontinue operation immediately if drone flies out of your field of view. Do not fly near spectators or animals. Keep spinning rotors away from fingers, hair, eyes and other body parts. Always launch from a flat surface. Never leave drone unattended while it is turned on. Return to Home and Follow Me modes do not have object avoidance detection. Use safety precautions when flying near trees, buildings, people or animals. Do not use while in a vehicle, on a skateboard/scooter/hoverboard or riding a bicycle. Read all enclosed information before operating.

### THIS PRODUCT CONTAINS A LITHIUM-POLYMER BATTERY 3.7V 1200mAh:

LiPo batteries have a severe risk of fire and injury if they are improperly handled or misused. They may explode, overheat or ignite. Read all following precautions and instructions regarding the care and use of LiPo batteries.

The LiPo battery is only to be used with the drone and charger included with this product.

- Keep away from flammable materials.
- Do not expose to direct sunlight.
- Do not place in fire or leave in hot places.
- Do not drop or make subject to strong impact.
- Keep dry and away from water.
- Remove exhausted battery as soon as possible and discard properly.
- Remove battery from the compartment if toy is not used for a long period of time.
- The supply terminals are not to be short circuited.
- Never throw battery in a fire or attempt to open outer casing.
- Do not leave battery connected to drone when not in use.
- Do not stress, press or drop the battery.
- Never charge battery unattended. When charging battery you should always remain in constant observation to monitor the charging process and react to potential problems that may occur.
- Disconnect with the charging wire if the battery is fully charged.
- Never store or charge battery inside the car in extreme temperatures, since extreme temperature could ignite fire.
- Use caution to avoid puncture of the battery. Puncture of battery may cause a fire.

LiPo Battery Disposal: LiPo batteries must be recycled or disposed of properly. They should not be disposed of with other household waste. Check your local laws and regulations for correct recycling and/or battery disposal.

#### AAA BATTERY CAUTIONS

- Do not use rechargeable batteries.
- Non-rechargeable batteries are not to be recharged.
- Do not mix old and new batteries and Do not mix alkaline, standard (carbon-zinc) or rechargeable (ni-cad, ni-mh, etc.) batteries.
- Batteries are to be inserted using correct polarity.
- Remove exhausted batteries as soon as possible and discard properly.
- Remove all batteries from compartment if toy is not used for a long period of time.
- The supply terminals are not to be short circuited.
- Batteries should be replaced by an adult.
- Never throw batteries in a fire or attempt to open the outer casing.

**WARNING:** Batteries are harmful if swallowed. Please keep away from children.

Battery Disposal: Dispose of batteries according to the local laws and regulations of your region. Some batteries may be recycled, and may be accepted for disposal at your local recycling center. If you are not able to identify the applicable rules in your area, please check the instructions of the battery manufacturer.

### FAILSAFE GUIDE

- When the drone turns upside down, the motors will stop spinning.
- When the drone goes out of range of the controller, it will begin to return to its home location. If the controller reconnects, press Home button to cancel the return.
- When the drone's battery is low, the LEDs on the drone will begin to blink rapidly, and a tone is played continuously on the controller. The drone will begin to return to its home location. Press Home button to cancel.
- When the drone's battery is depleted, the drone will automatically land itself in its current position. This automatic landing cannot be interrupted with the controller.
- When the propeller is jammed or blocked by an obstacle switch off the controller immediately to prevent possible or further damage.

This device complies with PART 15 of the FCC Rules. Operation is subject to the following two conditions. (1) This device may not cause harmful interference, and (2) this device must accept any interference received, including interference that may cause undesired operation.

CAUTION: Changes or modifications to this unit not expressly approved by the party responsible for compliance could void the user's authority to operate the equipment.

NOTE: This equipment has been tested and found to comply with the limits for a Class B digital device, pursuant to Part 15 of the FCC Rules. These limits are designed to provide reasonable protection against harmful interference in a residential installation. This equipment generates, uses and can radiate radio frequency energy and, if not installed and used in accordance with the instructions, may cause harmful interference to radio communications. However, there is no guarantee that interference will not occur in a particular installation. If this equipment does cause harmful interference to radio or television reception, which can be determined by turning the equipment off and on, the user is encouraged to try to correct the interference by one or more of the following measures: Reorient or relocate the receiving antenna - Increase the separation between the equipment and receiver - Connect the equipment into an outlet on a circuit different from that to which the receiver is connected - Consult the dealer or an experienced radio/TV technician for help.

Remove all packaging attachments before giving the toy to a child.

Not suitable for children under 3 years due to small parts that could be swallowed.

Conforms to product safety standards ASTM F963.

Keep instructions for future reference. Do not discard.



©2018 Skyrocket LLC, Los Angeles CA 90066 USA. All Rights Reserved. Sky Viper and Skyrocket and their respective logos are trademarks and/or registered trademarks of Skyrocket LLC. All other trademarks, logos and copyrights are the property of their respective owners, and there is no relationship express or implied with Skyrocket LLC.

MADE IN CHINA.

SKYROCKET

Google Play and the Google Play logo are trademarks of Google Inc.

Apple and the Apple logo are trademarks of Apple Inc., registered in the U.S. and other countries. App Store is a service mark of Apple Inc., registered in the U.S. and other countries.

The software included in this product contains copyrighted software that is licensed under the GPLv3. A copy of that license is included in our website at the URL below. You may obtain the complete Corresponding Source code from us for a period of three years after our last shipment of this product and/or spare parts therefor, which will be no earlier than 05-01-2021, on our website at <http://www.skyviper.com/opensource>

### WE'RE HERE TO HELP

For questions about this product:

Online: [skyviper.com/support](http://skyviper.com/support)

Phone:  
1-888-674-5650  
M-F 9am to 6pm PST